

christoph schmid
portfolio 2.semester architectural design
professor: marc angéil assistant: a.whiteside 2.assistant: a.kast
ETH Zürich 2004

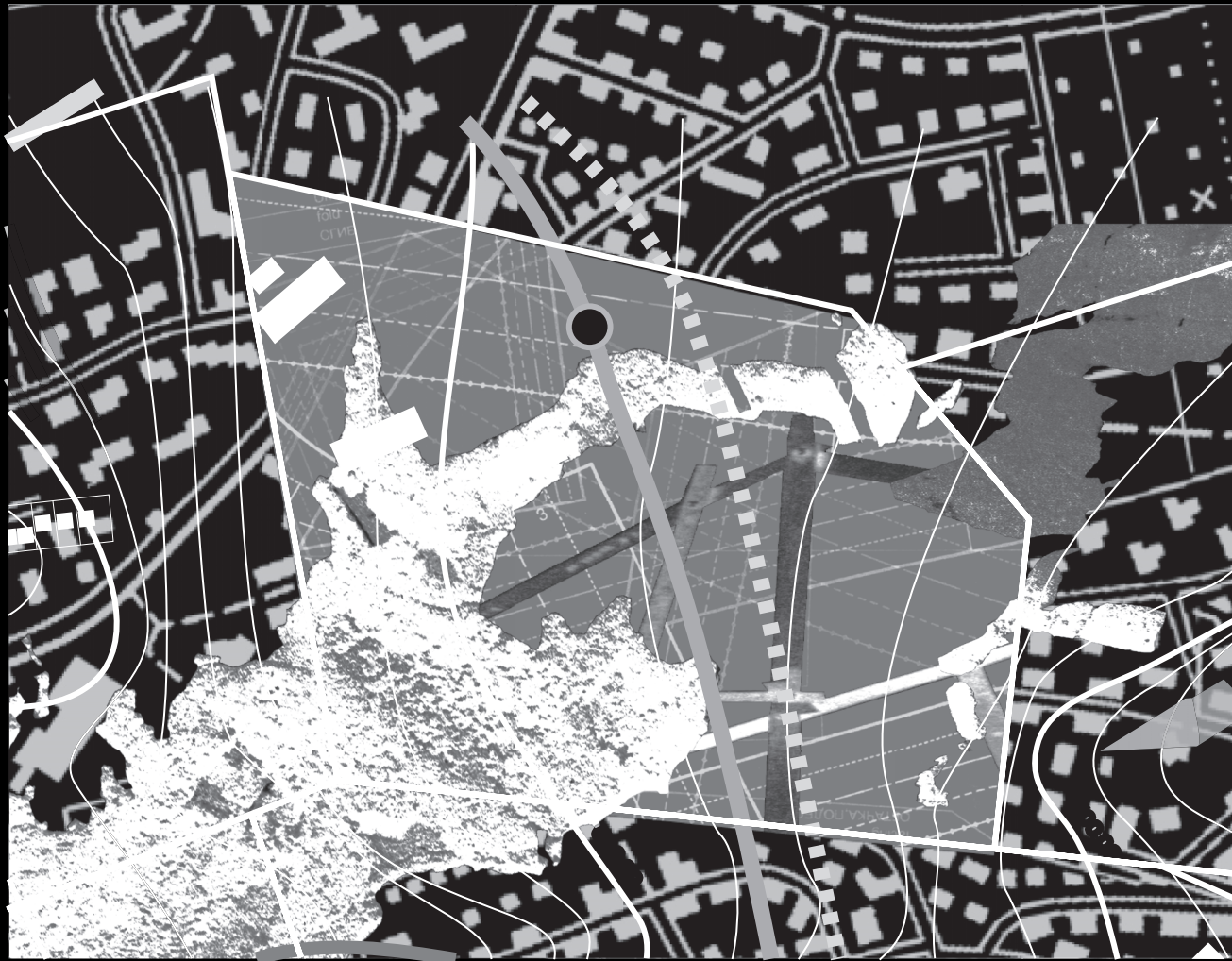

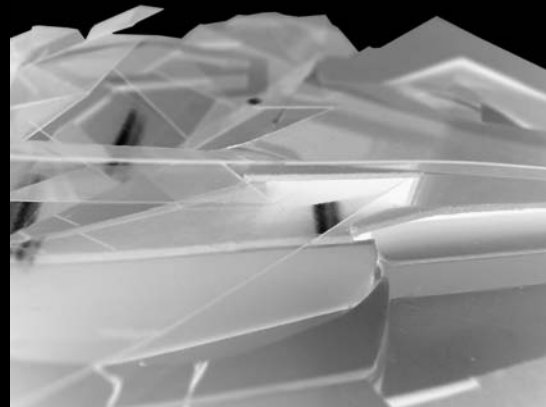

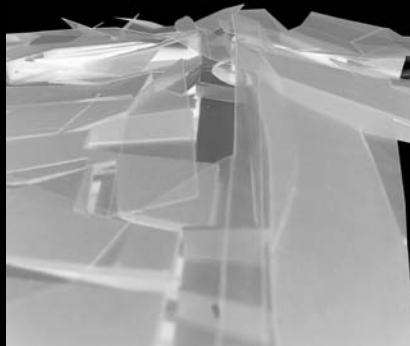

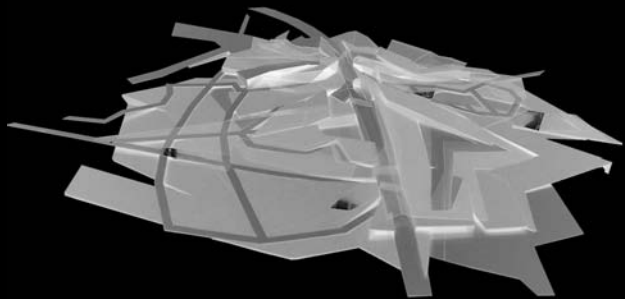

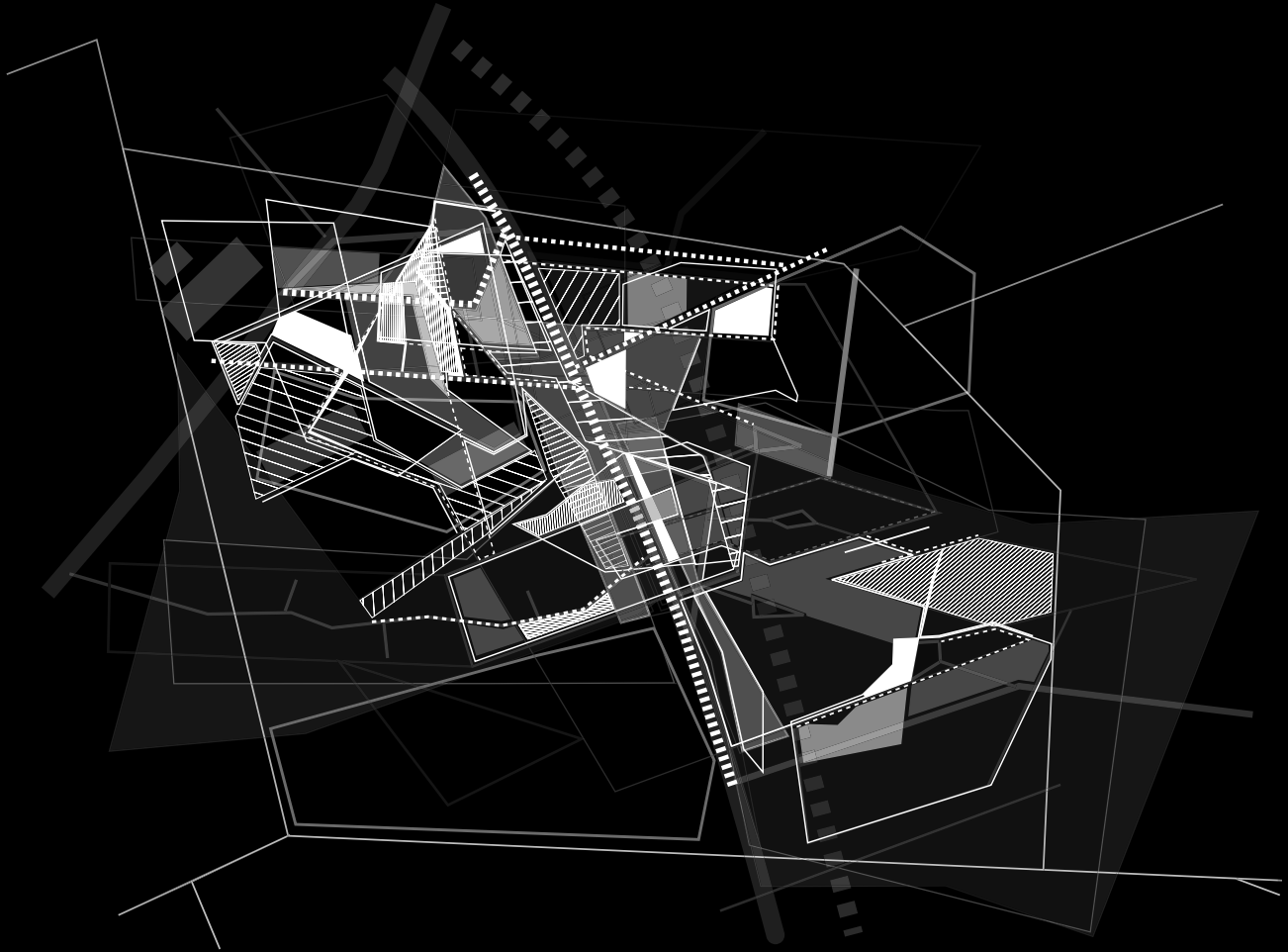

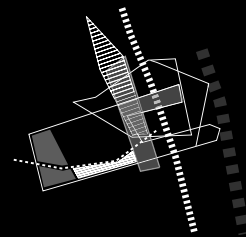
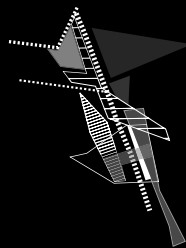
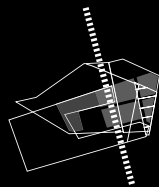
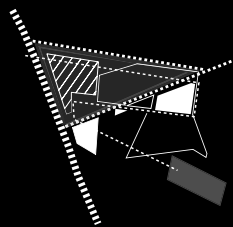
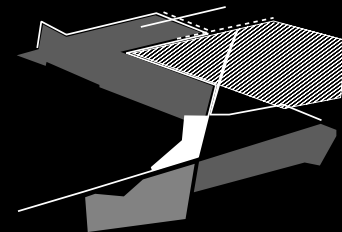
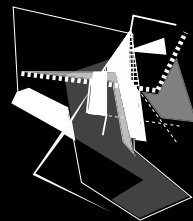
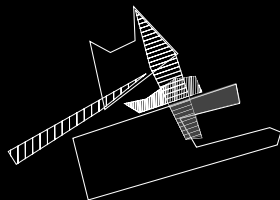
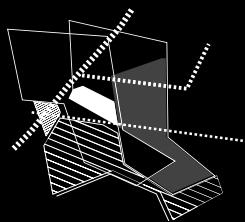

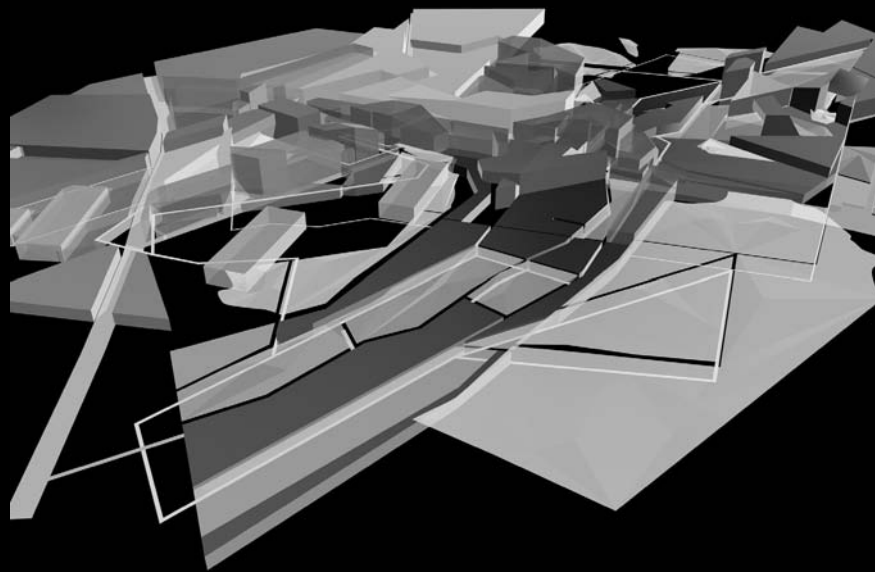
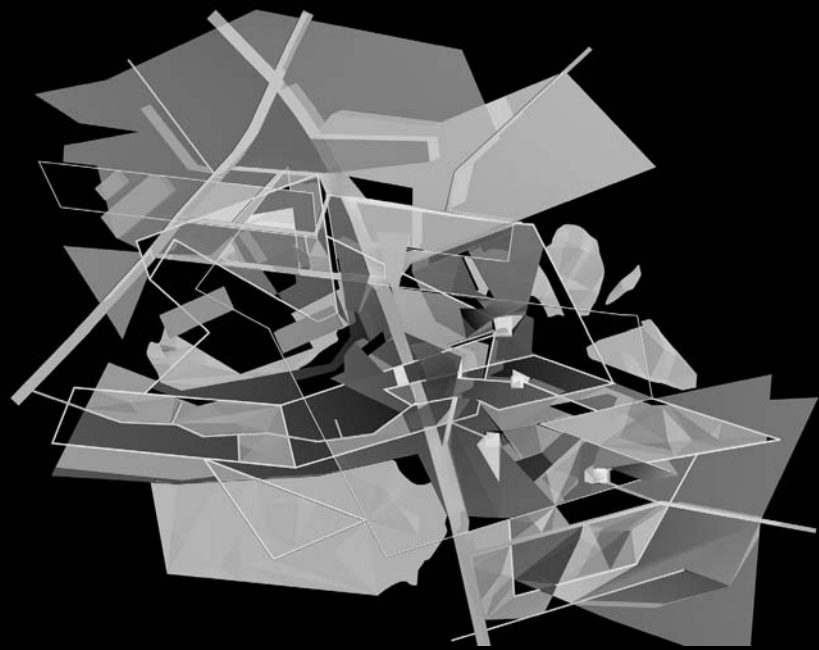

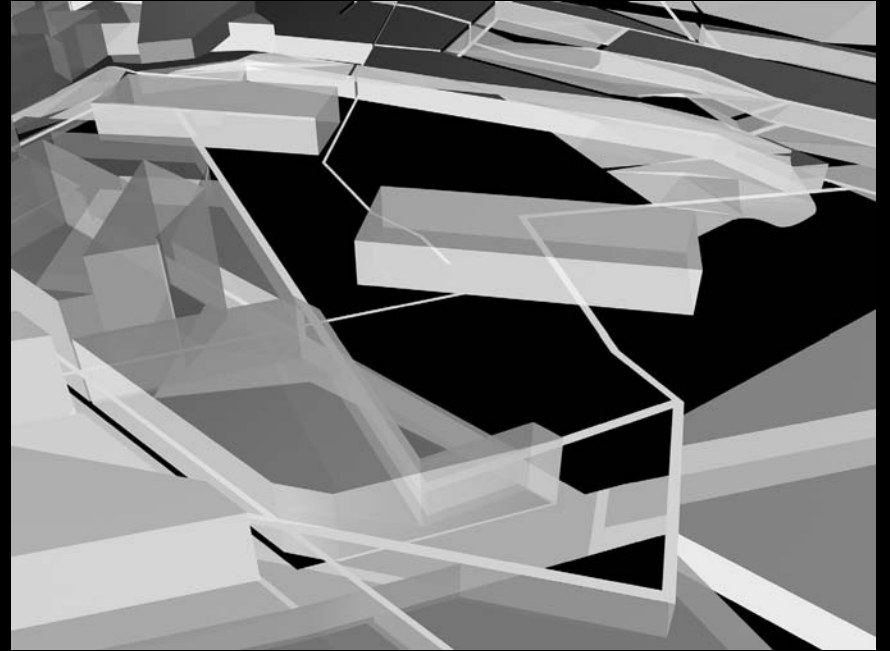
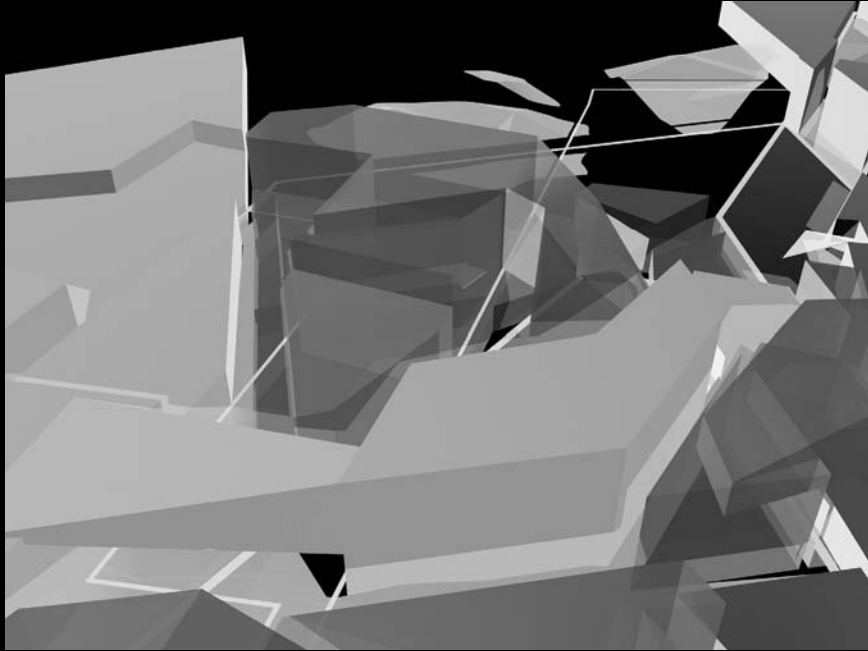

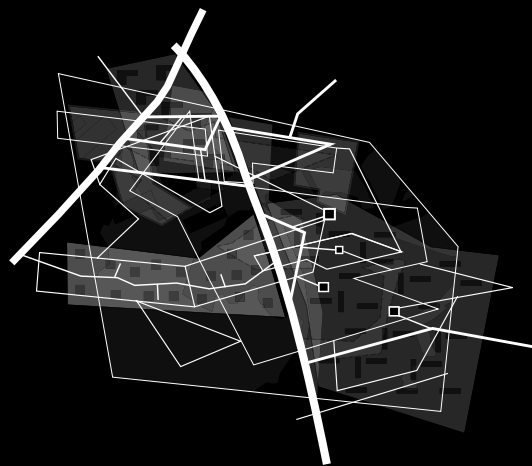
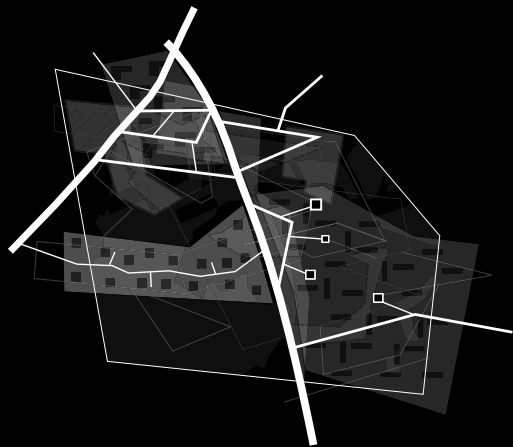
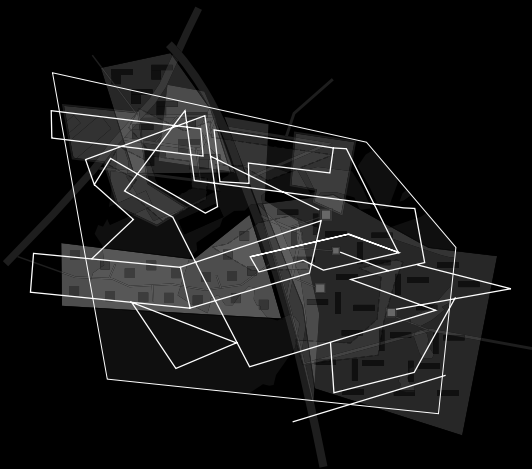

daily time in transit by purpose

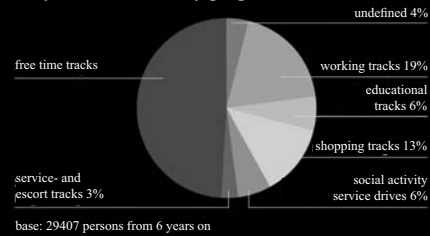

traffic run down by week-days

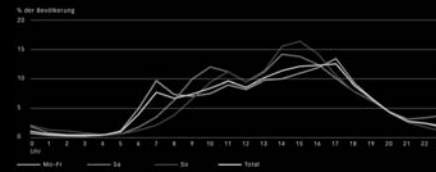

public transportation (all days; portions of stages in %)

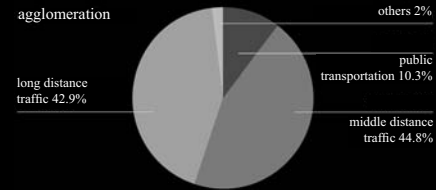

public transportation (all days; portions of stages in %)

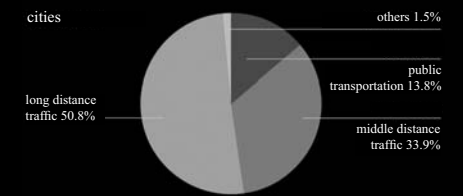

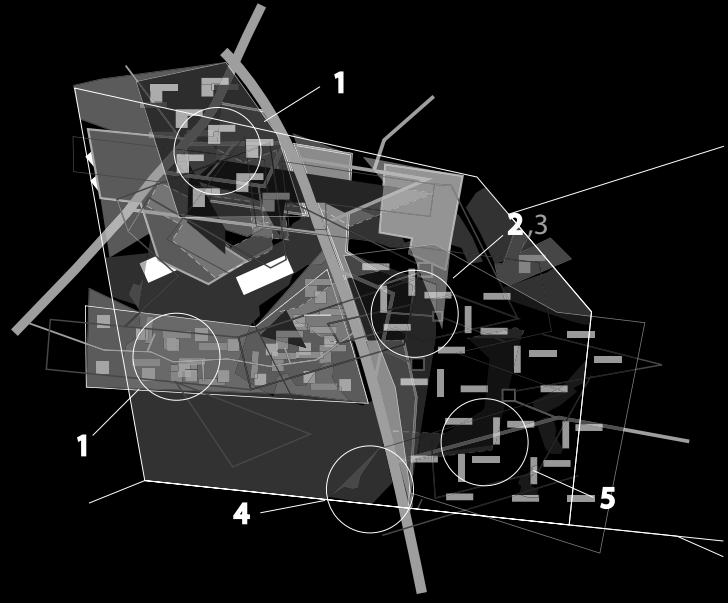
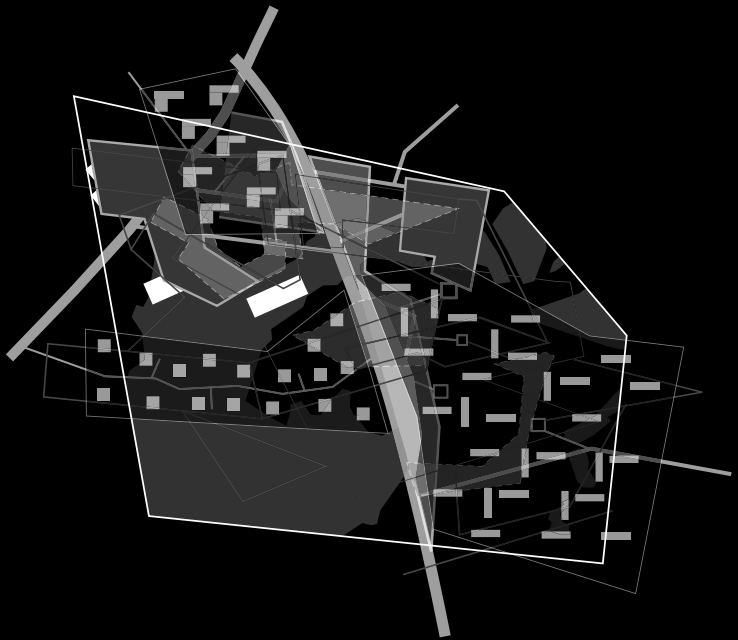

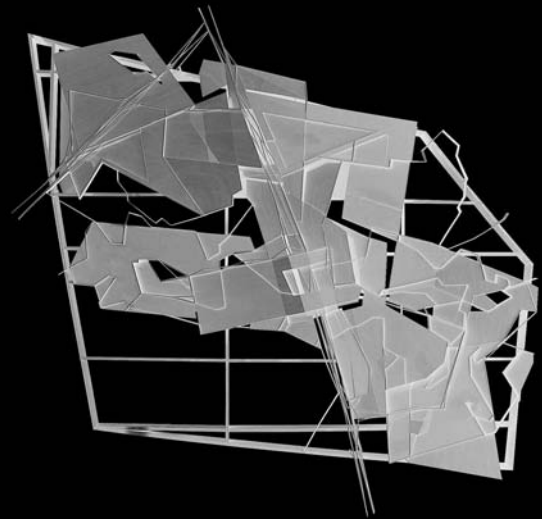
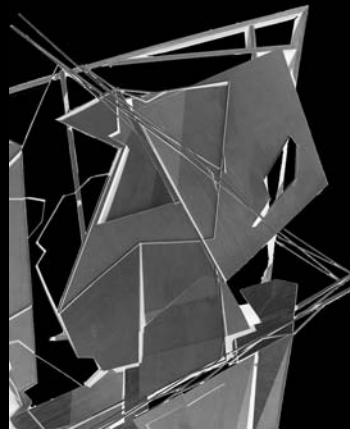
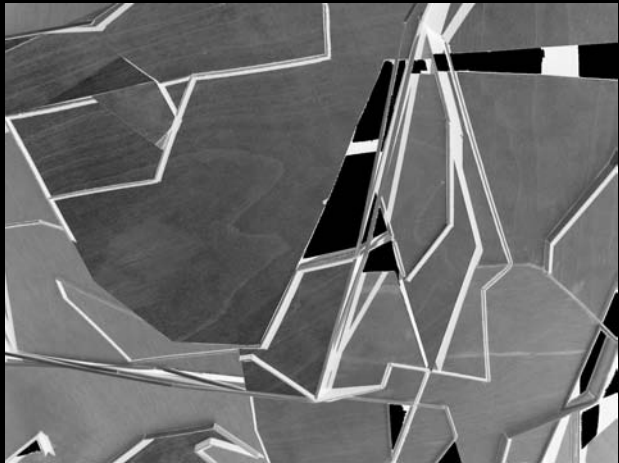

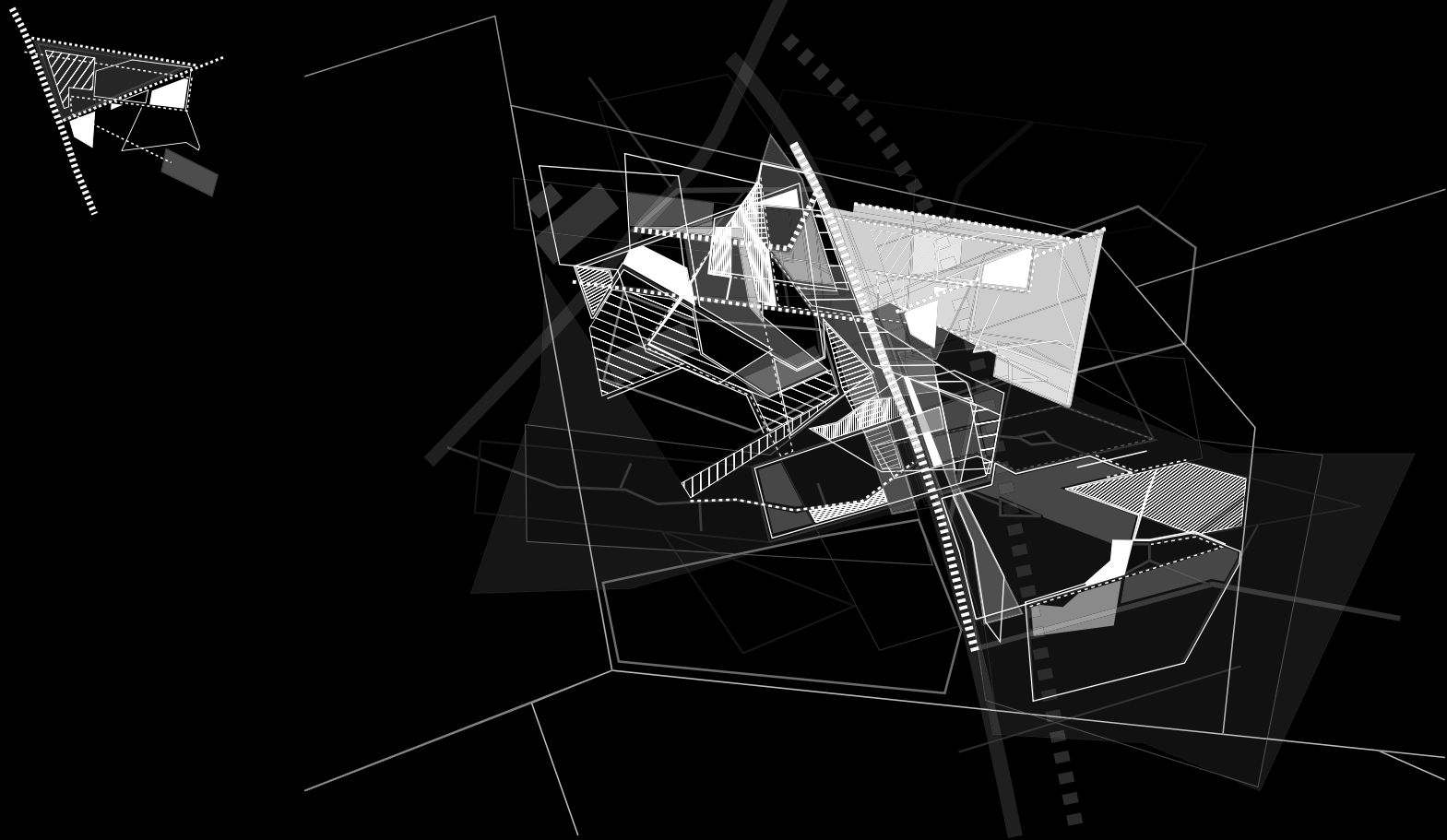

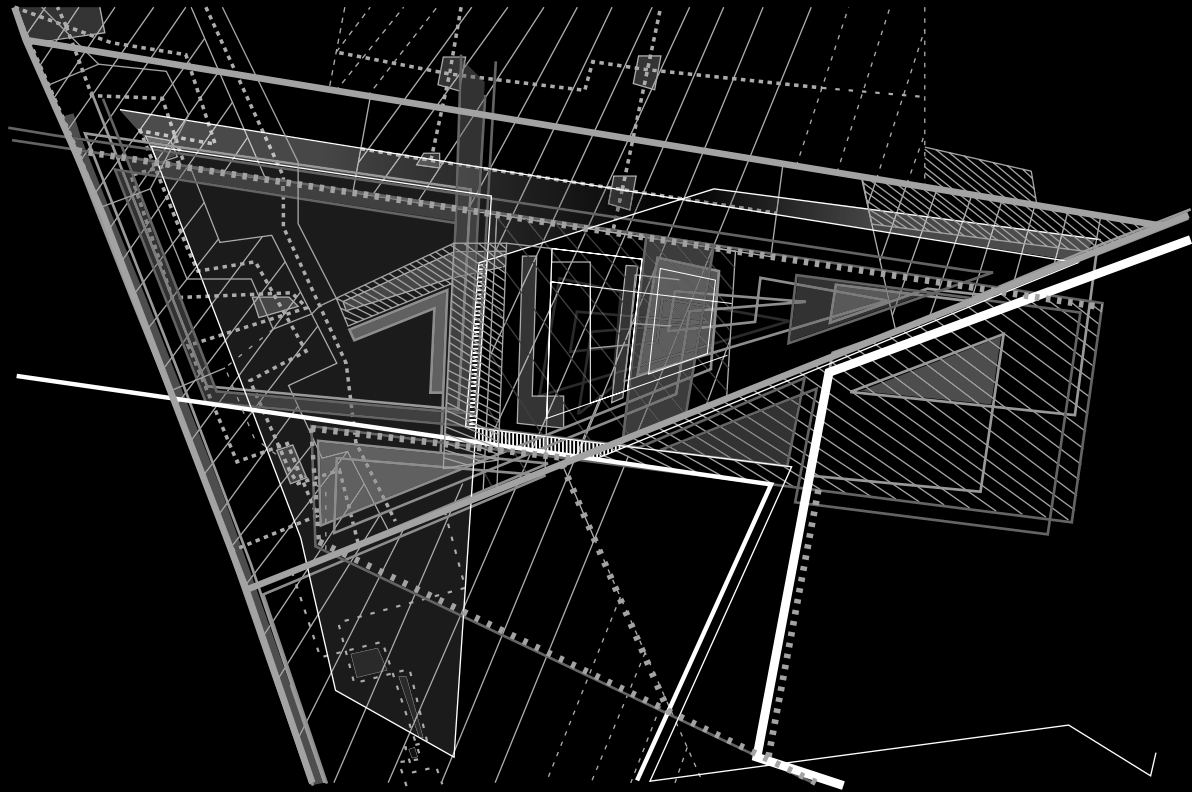

- work (woman) -> business
- free time (women) -> art
- free time in 10 years (women)
- work (man) -> security
- - - - work in 10 years (man)
- free time (man) -> culture
- building substance -> artificial
- - - - building substance in 10 years

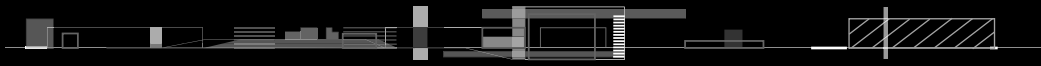

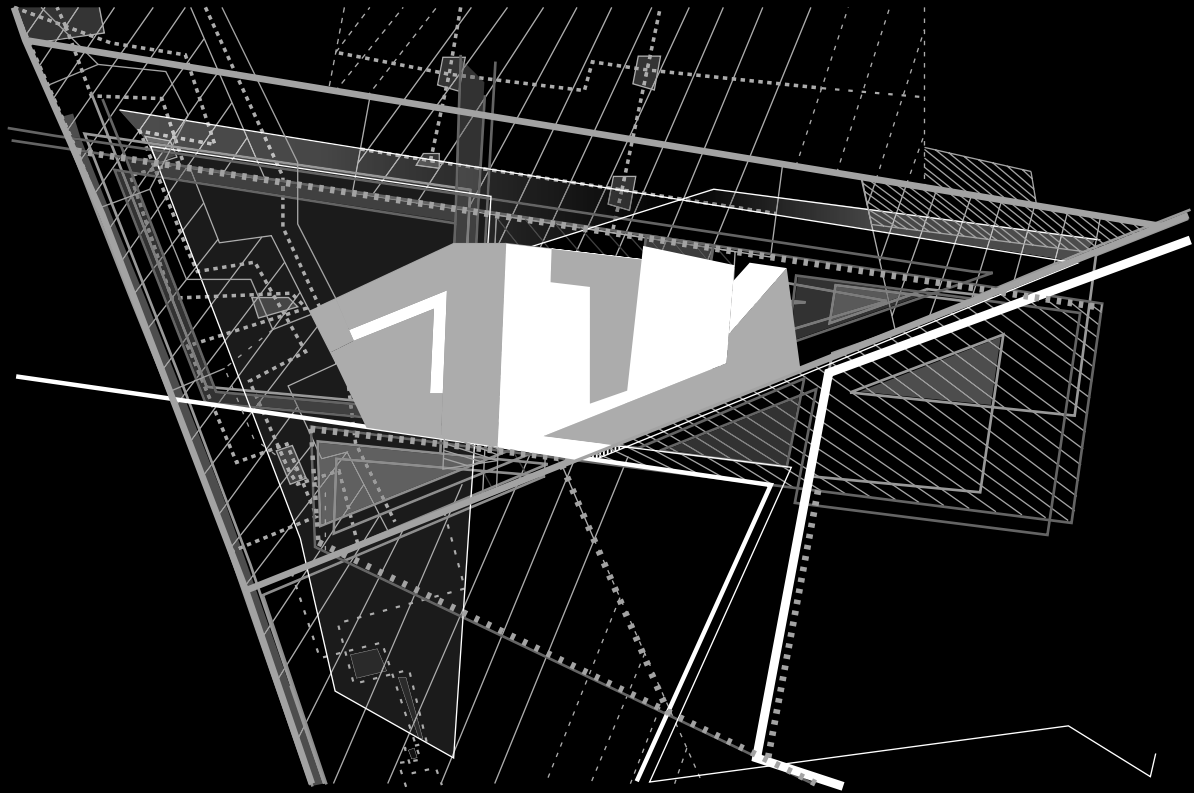

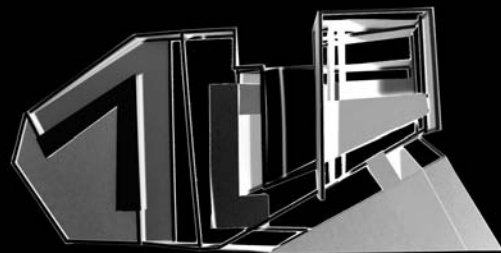
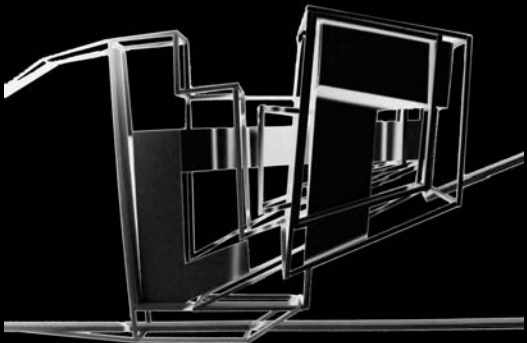
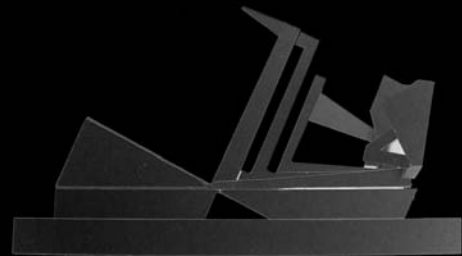
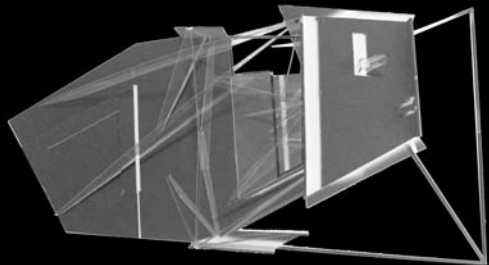

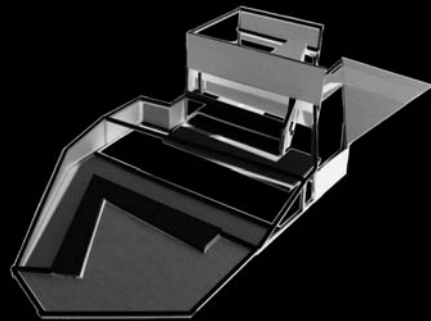
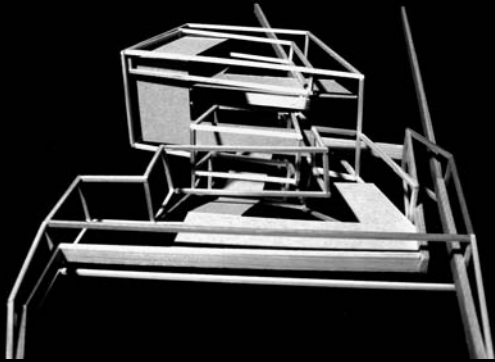
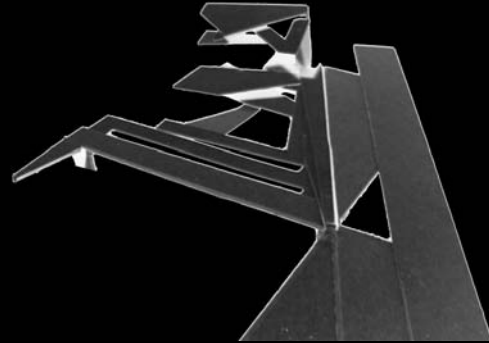
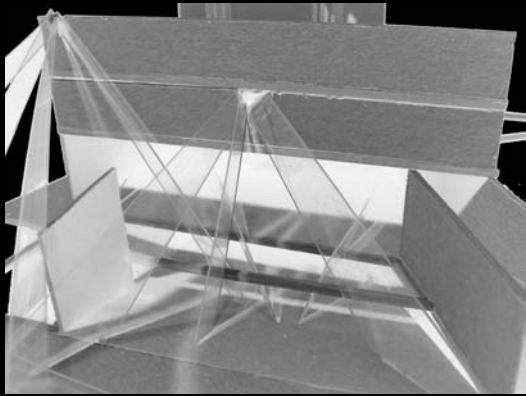

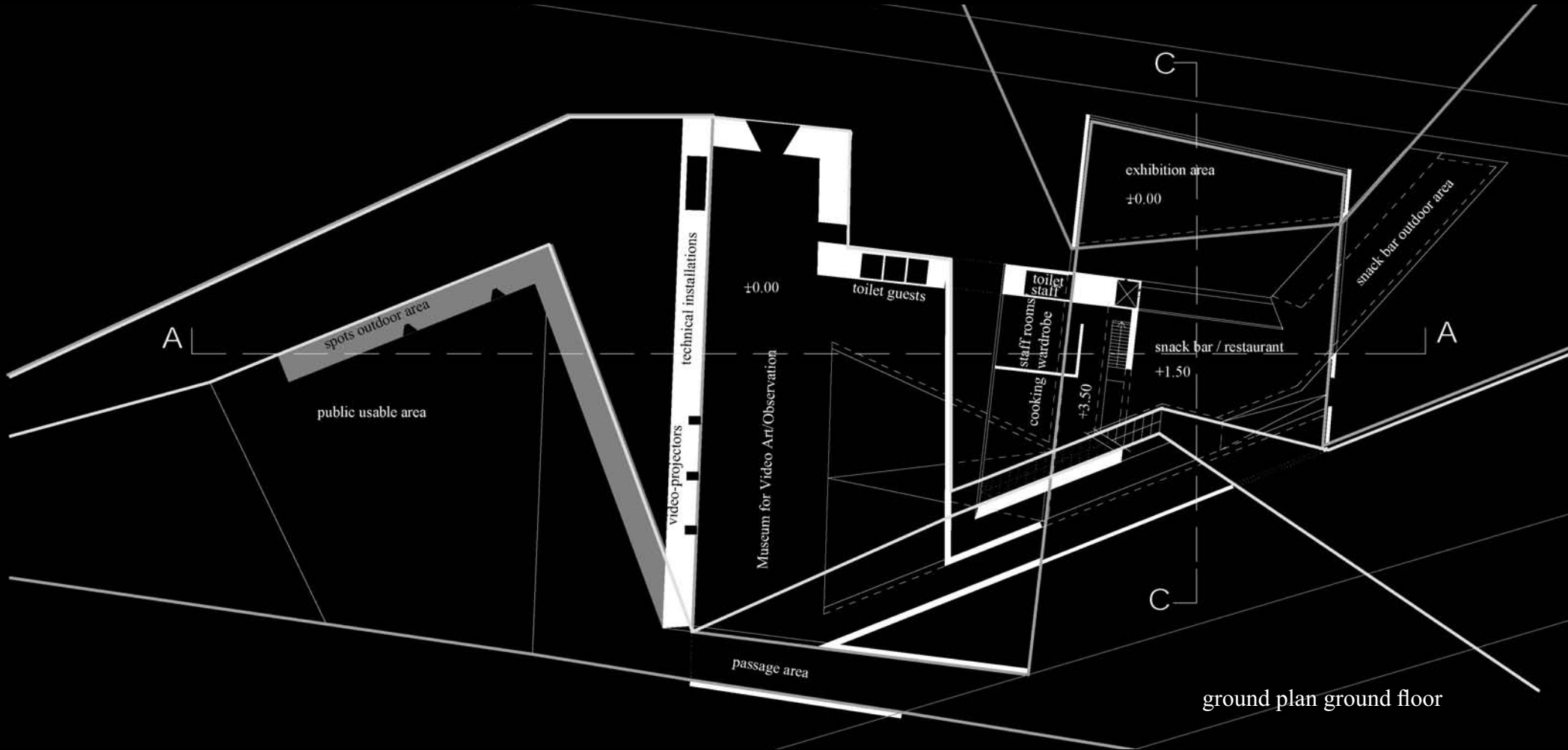

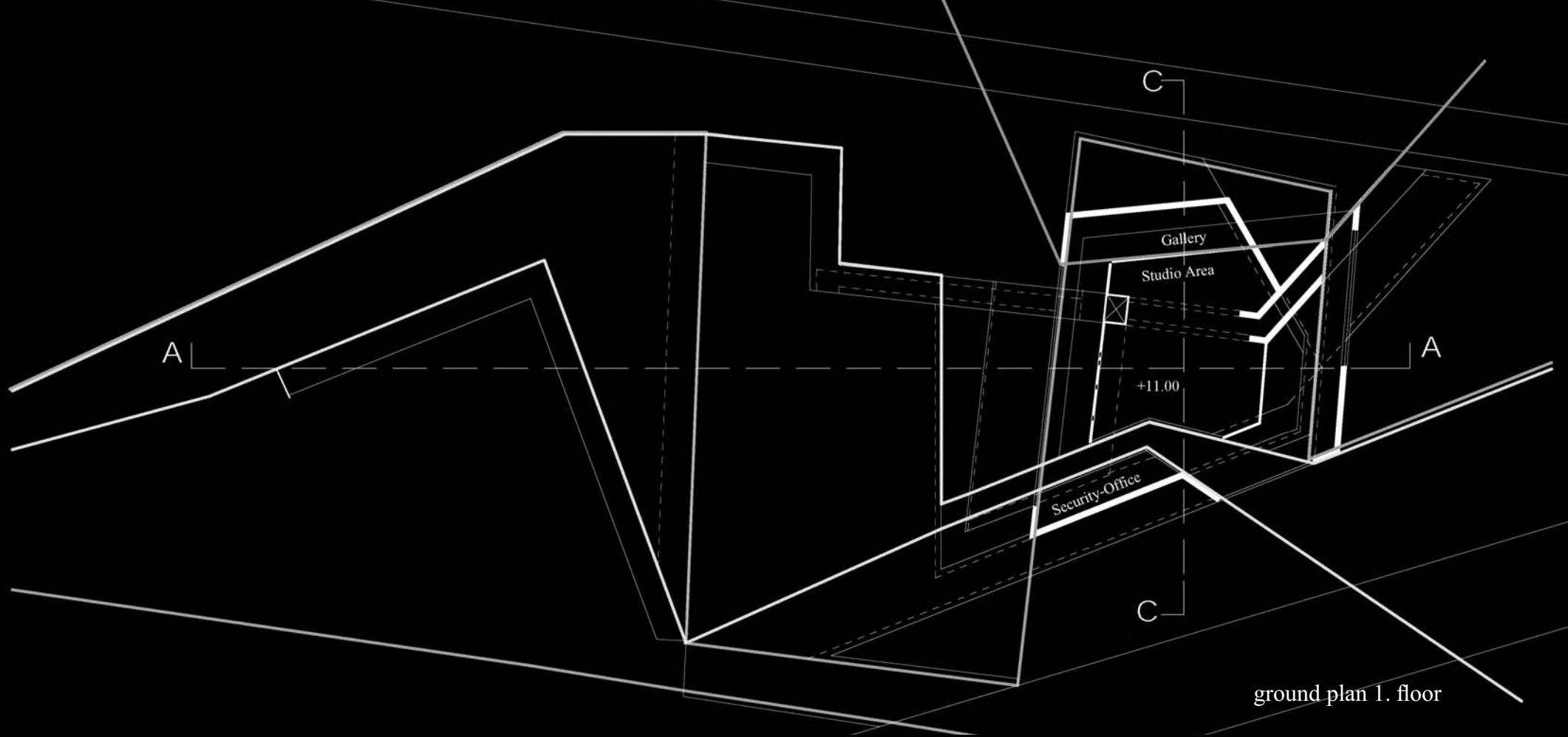

ground plan 1. floor

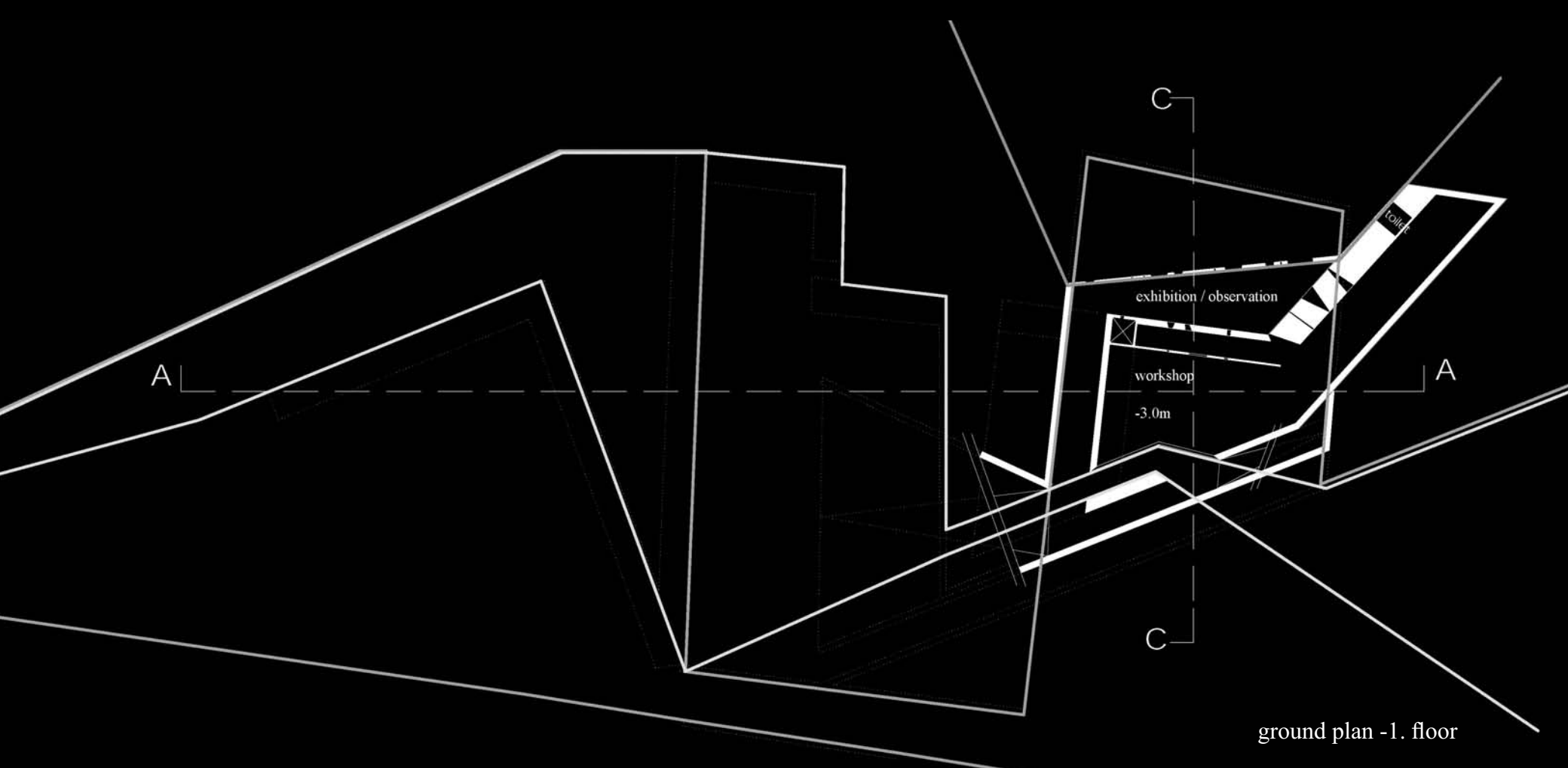

ground plan -1. floor

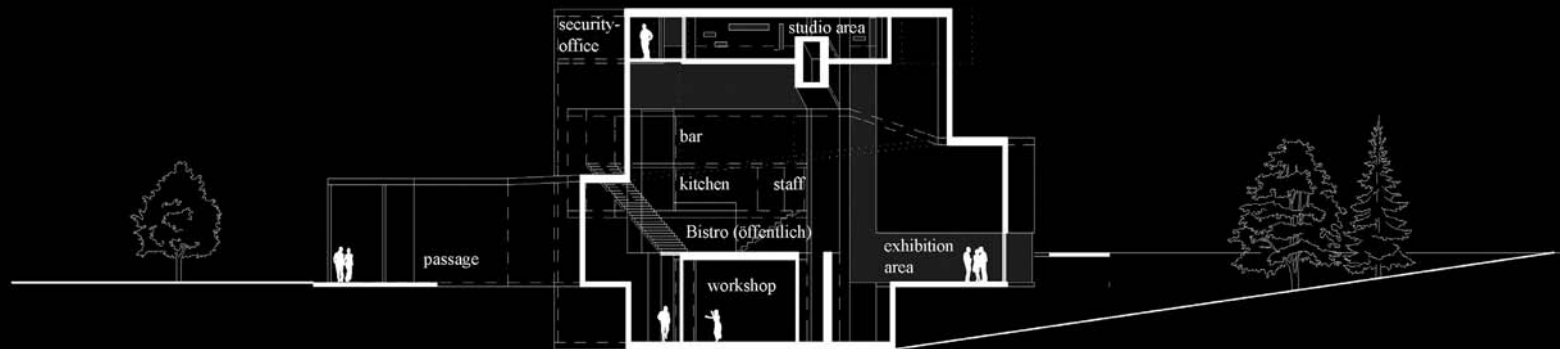

section C-C

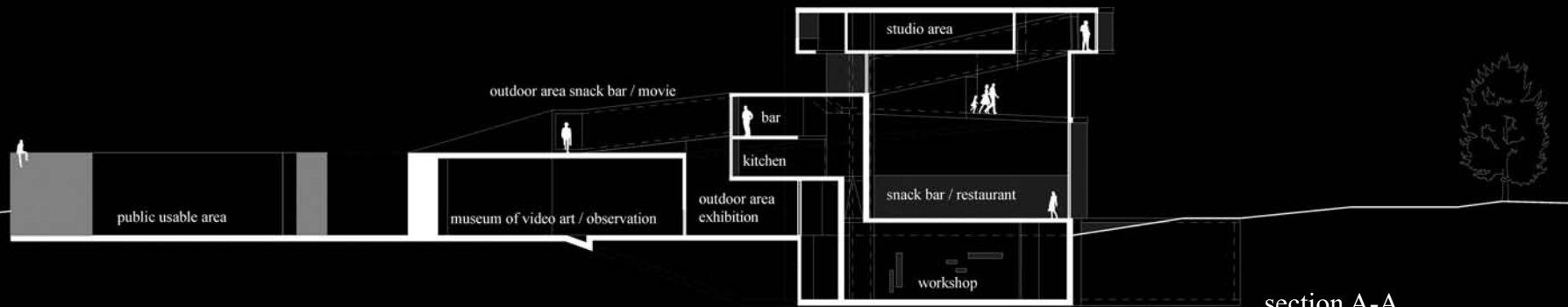

section A-A

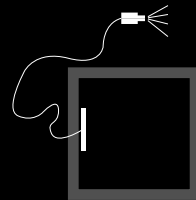
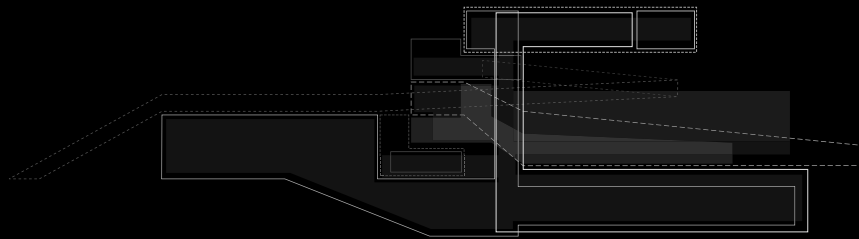

video

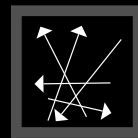

contact look

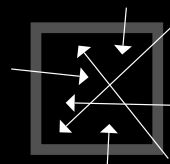

voyeur

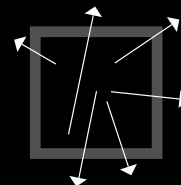

view

